



tattletale

portable alarm systems

www.tattletale.com

6269 Frost Road. Westerville OH 43082



**DOOR /
WINDOW
GUIDE**

DOOR / WINDOW SENSOR

1] learn it in

Access the Home Screen on your tattletale Consumer Unit.

- 1] press Settings
- 2] enter Primary PIN
- 3] press Advanced
- 4] press Sensors
- 5] press Add Sensor

It will ask for your sensor to be placed in "learn mode".

- 6] Press on center of Door/Window Sensor

note: The Consumer Unit will sound to indicate sensor has been learned in successfully

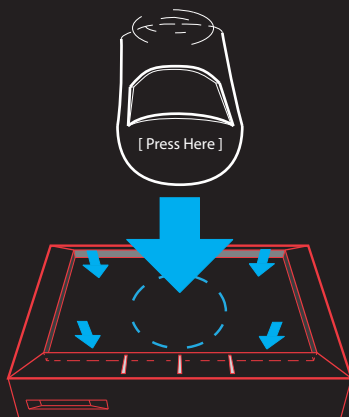

Vertical Mounting Orientation



Horizontal Mounting Orientation

2] set it up

Sensor is set to Entry/Exit Door [delay] by default.

- 1] set Name:
setting a specific name & location separates sensors
- 2] set Type:
instant or delay

use instant only if sensor will not be tripped during Entry/Exit to disarm system while in Away mode

- 3] allow Bypass:
determines whether it can be bypassed during arming cycle
- 4] Supervised*

3] mount it

Allow 24 hours for the tape to reach maximum strength



Sensor can be mounted Horizontal [as shown] or Vertical on door/doorframe

- 1] Location:
Transmitter on door
Magnet on doorframe
- 2] using Adhesive:
Clean and dry surface. Peel off yellow cover, place on back of sensor. Peel off white covering and place on desired mounting area. Press & Hold firmly for 10-15 seconds.
- 3] align Magnet:
Align with 3 notches on transmitter. Mount no more than .4" from Transmitter.

*Allowing this will cause the Consumer Unit to detect a problem with the sensor. A yellow trouble icon will appear on the Home Screen.

[text/email notifications can be set by an "Alarm Alert, Trouble Conditions" through "Advanced Features"]